

---

*Comfort-Cire*®

Century®

**MARS**  
Delivering Confidence

---

## PARTS LIST

# Horizontal/Side Discharge Condensing Units

CMA1412SF-1

# EXPLODED VIEW

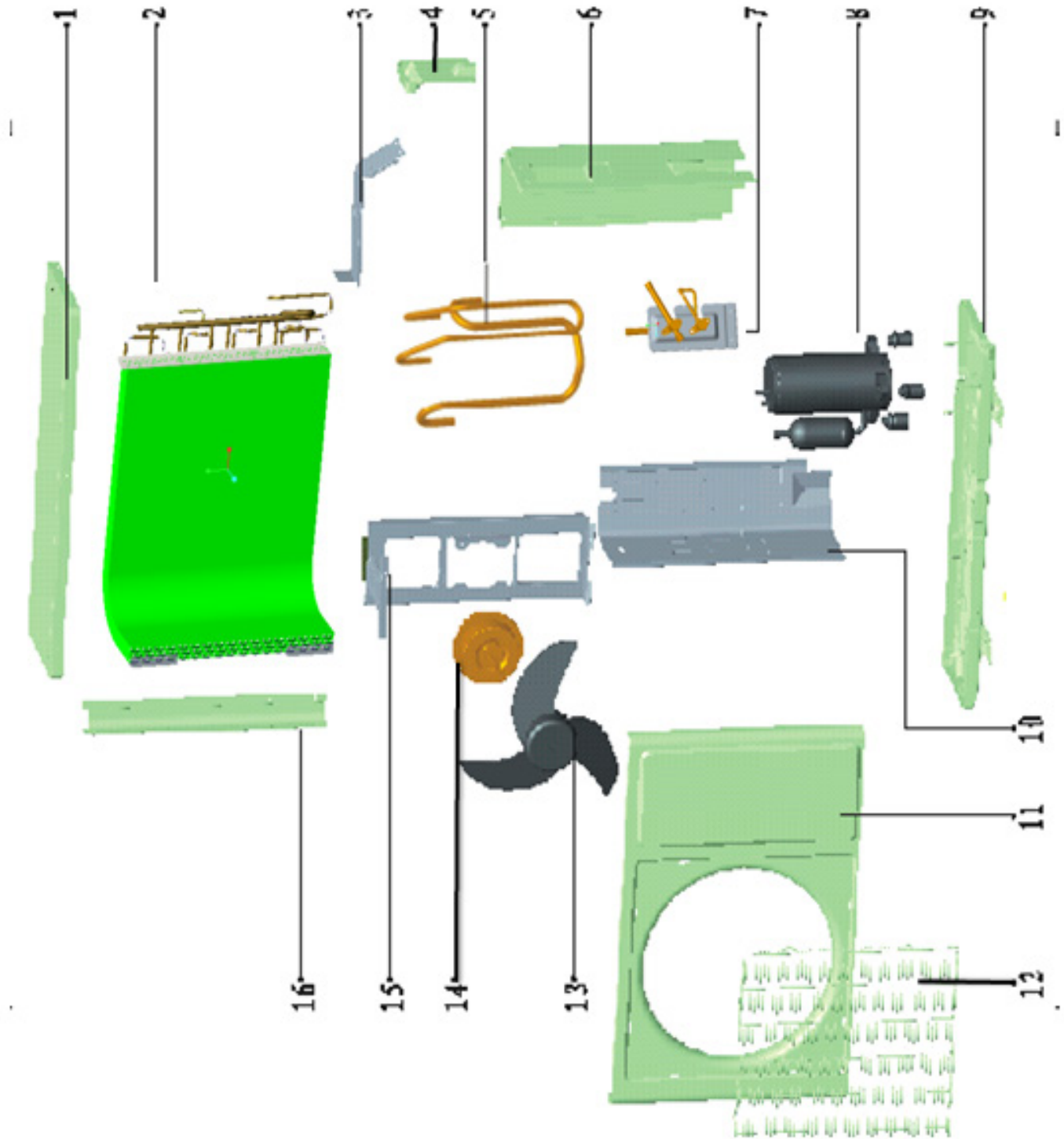

## REPLACEMENT PARTS

Location	Part Name	Quantity	Part No.
1	Cover	1	801227490015
2	Condenser parts	1	801532090003
2.1	Condenser assembly	1	801532090004
2.2	Condenser junction tube assembly	1	801632090006
2.3	Condenser collector assembly	1	801632090007
3	E-parts assy	1	803327490003
3.1	Capacitor clamp	1	801200100007
3.2	Groove clamp 3#	1	801102000015
3.3	Cover for E-parts	1	801227400021
3.4	Terminal	1	802401800090
3.5	Compressor capacitor	1	802401000063
3.6	Fan capacitor	1	802401100082
3.7	Sensor	1	802301000009
4	Handle	1	801219900166
5	Pipeline components	1	801632090010
5.1	Compressor suction pipe	1	801627490025
5.2	Compressor discharge pipe	1	801632090011
6	Right clapboard	1	801227800056
7	Valve holder assy	1	801232400020
7.1	Valve holder	1	801219900278
7.2	Service valve assembly (liquid)	1	801600200009
7.3	Service valve assembly (gas)	1	801600200010
8	Compressor assy	1	801401400154
9	Chassis	1	801227490013
10	Bulkhead	1	801232000023
11	Front panel	1	801232400067
12	Front top net	1	802900800076
13	Propeller fan	1	801100300009
14	Fan motor	1	802400400703
15	Holder for fan motor	1	801219900112
16	Vertical shaft	1	801219900346

---

Due to ongoing product improvements, specifications and dimensions are subject to change and correction without notice or incurring obligations. Determining the application and suitability for use of any product is the responsibility of the installer. Additionally, the installer is responsible for verifying dimensional data on the actual product prior to beginning any installation preparations.

Incentive and rebate programs have precise requirements as to product performance and certification. All products meet applicable regulations in effect on date of manufacture; however, certifications are not necessarily granted for the life of a product. Therefore, it is the responsibility of the applicant to determine whether a specific model qualifies for these incentive/rebate programs.

*Comfort-Aire*®

1900 Wellworth Ave., Jackson, MI 49203 • Ph. 517-787-2100 • [www.marsdelivers.com](http://www.marsdelivers.com)

